

DAU

HBGQ
METAL ELECTRONIC SWITCH



HBGQ Series

A

B

C

D

E

F

G



型号说明 Model Explanation

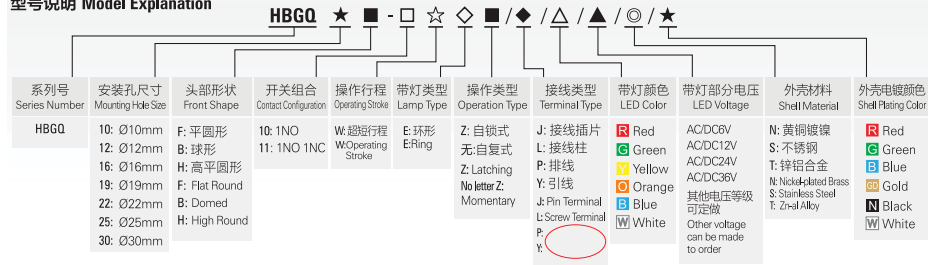

性能参数 Parameters

开关额定值 Switch Rating	DC:50mA/12V; AC:1A/125V	防护等级 Degree of Protection	IP65 / IP67
环境温度 Operating Temperature	-40°C ~ +80°C	操作压力 Operating Pressure	3~5N
接触电阻 Contact Resistance	≤50MΩ	操作行程 Operating Stroke	0.5mm
绝缘电阻 Insulation Resistance	≥100MΩ	螺母扭矩 Screw Torque	5~14N
介电强度 Dielectric Strength	AC250V	外壳 Shell material	黄铜镀镍/不锈钢 Nickel-plated Brass/Stainless Steel
机械寿命 Mechanical Life	≥1000,000次	按键 Press key material	不锈钢 Stainless steel
电气寿命 Electrical Life	≥50,000次	底座 Base material	塑料/底座 Plastic base
开关组合 Contact Configuration	1NO, 1NC	触点 Contact material	银合金 Silver alloy
表面防腐等级 Explosion proof grade	IK08-1K10(针对金属材料)		

LED灯珠规格 LED Lamp Specifications

灯珠类型 Lamp Type	双向LED灯珠(交流通用) Bi-directional LED lamp (AC DC Universal)	额定电流 Rated Current	约20mA about 20mA
额定电压 Rated Voltage	1.8V、2.8V、6V、12V、24V、36V	发光颜色 Color	Red Green Blue White
		寿命 Life	50000小时(参考值) 50000 hours (reference value)

注：如需单向直流LED灯珠可定做；其他电压规格可按要求定做。
Note: Unidirectional DC LED lamp can be customized if needed; other voltage specifications could be special made

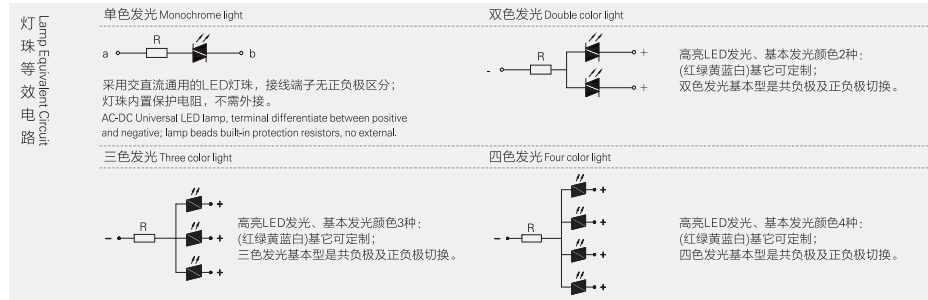

引脚说明 Pin Description

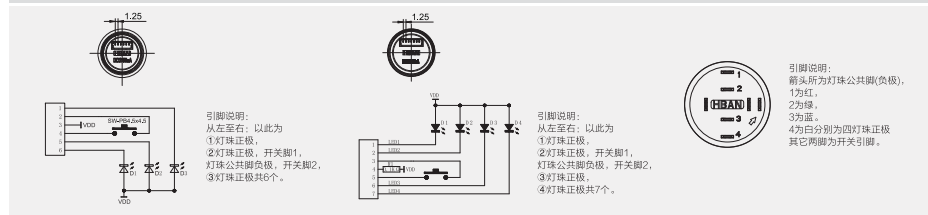

产品特点 Features

- 照明是它的最大亮点，每个开关的多种彩色照明，减少额定控制指示的成本；
- 按键操作行程短，约0.5mm；
- 尾部接线方式多样化：接线插片/接线柱/排线/引线。

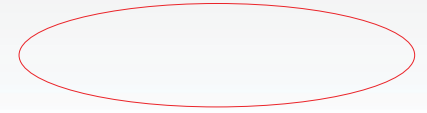

部分产品焊接注意事项 Welding Precautions

- 任何不正确的焊接操作都可能导致产品塑料变形、开关接触不良等。用户在使用引脚式按钮开关、信号灯时，因焊接不当导致产品损坏的现象时有发生，故敬请各位用户在接线操作时务必注意以下几点：
- 选择合适的电烙铁，加快焊接速度，建议使用30W以下电烙铁在320°C时2秒内完成焊接。
- 助焊剂必须适量，焊接时尽量将开关引脚朝下。
- 尽量采用插线端子连接，避免焊接连接。

- Any improper welding operation may lead to product plastic deformation, poor switch contact. Users using pin-type button switches, lights, due to improper welding damage to the product. Phenomenon occurs from time to time, so please be sure to pay attention to the following points in the wiring operation:
- Choose the right electric iron, speed up the welding speed, it is recommended to use the following 30W electric iron at 320°C When 2 seconds to finish welding.
- Flux must be moderate, try to switch the pin down when welding.
- Try to use plug-in terminals to avoid welding connections.

防护与安装说明 Protection and installation instructions

金属按钮开关外壳采用金属材料，与塑料开关相比，不紧增强了其美观性，外观颜色可多样化，并且大幅度提升了头部安装面板以上其防尘防水性能、防腐性能及耐腐蚀性等特点。防水等级IP65，防爆能力IK08-1K10。

Pushbutton use metal housing, not only the appearance would be more beautiful and multi-colorful compared with plastic indicator, but also enhance the dustproof and waterproof, explosion resistance and corrosion resistance performance of the head (above the panel mount), etc. IP65 waterproof, Explosion-proof IK08-1K10.

内部防尘、防水结构



内部防水密封圈

外部O型密封圈安装方法

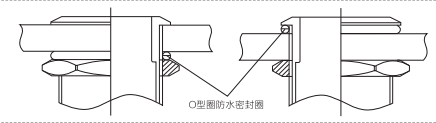

O型圈防水密封圈

定制尾部接线方式 Terminal can be customized



安装效果预览 Installation Effect Preview

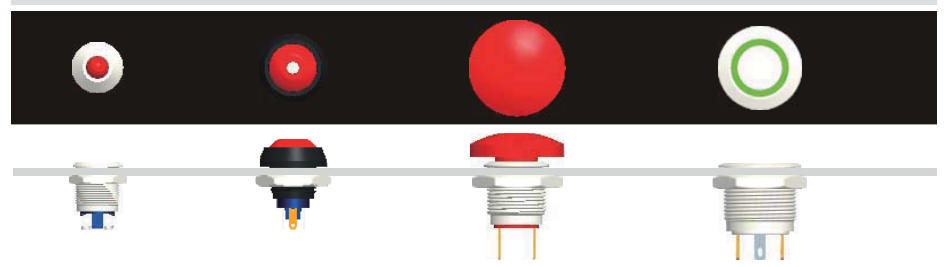



HBGQ10F-11 ■/●/◎

- 安装孔尺寸: Ø10mm
- 头部形状: 平圆形
- 开关额定值: 100mA/DC12V
- 开关组合: 1NO 1NC
- 操作类型: 自复式/自锁式
- 接线类型: 接线插片
- 外壳材料: 黄铜镀镍/不锈钢
- 防护等级: IP67, IK08
- **Mounting Hole Size: Ø10mm**
- **Shape: Flat Round**
- **Switch Rating: 100mA/DC12V**
- **Contact Configuration: 1NO 1NC**
- **Operation Type: Momentary / Latching**
- **Terminal Type: Pin Terminal**
- **The Crust Material: Nickel-plated Brass/ Stainless Steel**
- **Protection Degree: IP67, IK08**

HBGQ10H-11 ■/●/◎

- 安装孔尺寸: Ø10mm
- 头部形状: 高平圆形
- 开关额定值: 100mA/DC12V
- 开关组合: 1NO 1NC
- 操作类型: 自复式/自锁式
- 接线类型: 接线插片
- 外壳材料: 黄铜镀镍/不锈钢
- 防护等级: IP67, IK08
- **Mounting Hole Size: Ø10mm**
- **Shape: High Round**
- **Switch Rating: 100mA/DC12V**
- **Contact Configuration: 1NO 1NC**
- **Operation Type: Momentary / Latching**
- **Terminal Type: Pin Terminal**
- **The Crust Material: Nickel-plated Brass/ Stainless Steel**
- **Protection Degree: IP67, IK08**

HBGQ12SF-10W◎

- 安装孔尺寸: Ø12mm
- 头部形状: 平圆形
- 操作行程: 约0.5mm
- 开关额定值: 100mA/DC12V
- 开关组合: 1NO
- 操作类型: 自复式
- 接线类型: 接线插片
- 外壳材料: 黄铜镀镍/不锈钢
- 防护等级: IP67, IK08
- **Mounting Hole Size: Ø12mm**
- **Shape: Flat Round**
- **Operating stroke: about 5mm**
- **Switch Rating: 100mA/DC12V**
- **Contact Configuration: 1NO**
- **Operation Type: Momentary**
- **Terminal Type: Pin Terminal**
- **The Crust Material: Nickel-plated Brass/ Stainless Steel**
- **Protection Degree: IP67, IK08**

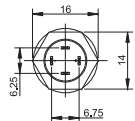
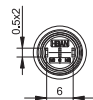
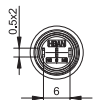
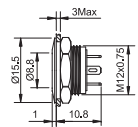
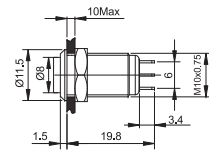
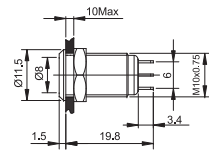

HBGQ12SF-10WE/△/▲/◎

- 安装孔尺寸: Ø12mm
- 头部形状: 平圆形带灯
- 操作行程: 约0.5mm
- 开关额定值: 100mA/DC12V
- 开关组合: 1NO
- 操作类型: 自复式
- 接线类型: 接线插片
- 灯颜色: 红/绿/黄/蓝/白
- 外壳材料: 黄铜镀镍/不锈钢
- 防护等级: IP67, IK08
- **Mounting Hole Size: Ø12mm**
- **Shape: Flat Round Ring Illuminated**
- **Operating stroke: about 5mm**
- **Switch Rating: 100mA/DC12V**
- **Contact Configuration: 1NO**
- **Operation Type: Momentary**
- **Terminal Type: Pin Terminal**
- **Lamp Color: Red/Green/Yellow/Orange Blue/White**
- **The Crust Material: Nickel-plated Brass/ Stainless Steel**
- **Protection Degree: IP67, IK08**

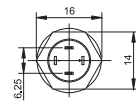
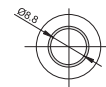
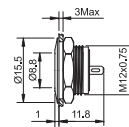

HBGQ12F-11 ■/●/◎

- 安装孔尺寸: Ø12mm
- 头部形状: 平圆形
- 开关额定值: 100mA/DC12V
- 开关组合: 1NO 1NC
- 操作类型: 自复式/自锁式
- 接线类型: 接线插片
- 外壳材料: 黄铜镀镍/不锈钢
- 防护等级: IP67, IK08
- **Mounting Hole Size: Ø12mm**
- **Shape: Flat Round**
- **Switch Rating: 100mA/DC12V**
- **Contact Configuration: 1NO 1NC**
- **Operation Type: Momentary / Latching**
- **Terminal Type: Pin Terminal**
- **The Crust Material: Nickel-plated Brass/ Stainless Steel**
- **Protection Degree: IP67, IK08**

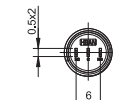
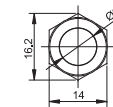
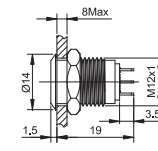

HBGQ12H-11 ■/●/◎

- 安装孔尺寸: Ø12mm
- 头部形状: 高平圆形
- 开关额定值: 100mA/DC12V
- 开关组合: 1NO 1NC
- 操作类型: 自复式/自锁式
- 接线类型: 接线插片
- 外壳材料: 黄铜镀镍/不锈钢
- 防护等级: IP67, IK08
- **Mounting Hole Size: Ø12mm**
- **Shape: High Round**
- **Switch Rating: 100mA/DC12V**
- **Contact Configuration: 1NO 1NC**
- **Operation Type: Momentary / Latching**
- **Terminal Type: Pin Terminal**
- **The Crust Material: Nickel-plated Brass/ Stainless Steel**
- **Protection Degree: IP67, IK08**

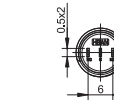
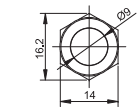
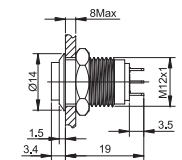



HBGQ12B-11■/T/★

- 安装孔尺寸: Ø12mm
- 头部形状: 球形钮
- 开关额定值: 100mA/DC12V
- 开关组合: 1NO 1NC
- 操作类型: 自复式/自锁式
- 接线类型: 接线插片
- 外壳材料: 锌铝合金
- 电镀颜色: 红/绿/蓝/金/黑/白
- 防护等级: IP67, IK08
- **Mounting Hole Size: Ø12mm**
- **Shape: Domed**
- **Switch Rating: 100mA/DC12V**
- **Contact Configuration: 1NO 1NC**
- **Operation Type: Momentary / Latching**
- **Terminal Type: Pin Terminal**
- **The Crust Material: Zn-al alloy(Black)**
- **Shell Plating Color: Red / Green / Blue / Gold / Black / White**
- **Protection Degree: IP67, IK08**

HBGQ19F-10WE/J▲/▲/◎

- 安装孔尺寸: Ø19mm
- 头部形状: 平圆形环带灯
- 操作行程: 约0.5mm
- 开关额定值: 50mA/DC12V
- 开关组合: 1NO
- 操作类型: 自复式
- 接线类型: 接线插片
- 灯珠颜色: 红/绿/黄/蓝/白
- 外壳材料: 黄铜镀镍/不锈钢
- 防护等级: IP65, IK08
- **Mounting Hole Size: Ø19mm**
- **Shape: Flat Round Ring Illuminated**
- **Operating stroke: about 5mm**
- **Switch Rating: 50mA/DC12V**
- **Contact Configuration: 1NO**
- **Operation Type: Momentary**
- **Terminal Type: Pin Terminal**
- **Lamp Color: Red/Green/Yellow/Orange Blue/White**
- **The Crust Material: Nickel-plated Brass/ Stainless Steel**
- **Protection Degree: IP65, IK08**

HBGQ19F-11WE/J▲/▲/▲/▲/▲/◎

- 安装孔尺寸: Ø19mm
- 头部形状: 平圆形环带灯
- 操作行程: 约0.5mm
- 开关额定值: 1A/AC125V
- 开关组合: 1NO 1NC
- 操作类型: 自复式
- 接线类型: 接线插片
- 灯珠颜色: 红/绿/黄/蓝/白
- 灯珠颜色多种选择(同时可安装3种颜色), 达到信号识别多样化
- 外壳材料: 黄铜镀镍/不锈钢
- 防护等级: IP65, IK08
- **Mounting Hole Size: Ø19mm**
- **Shape: Flat Round Ring Illuminated**
- **Operating stroke: about 5mm**
- **Switch Rating: 1A/AC125V**
- **Contact Configuration: 1NO 1NC**
- **Operation Type: Momentary**
- **Terminal Type: Pin Terminal**
- **Lamp Color: Red/Green/Yellow/Orange/Blue/White**
- **The Crust Material: Nickel-plated Brass/ Stainless Steel**
- **Protection Degree: IP65, IK08**

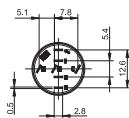
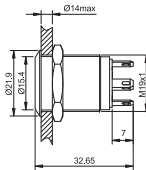
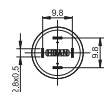
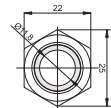
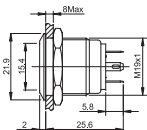
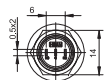
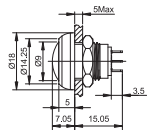

HBGQ19F-10WE/L▲/▲/◎

- 安装孔尺寸: Ø19mm
- 头部形状: 平圆形环带灯
- 操作行程: 约0.5mm
- 开关额定值: 50mA/DC12V
- 开关组合: 1NO
- 操作类型: 自复式
- 接线类型: 接线柱
- 灯珠颜色: 红/绿/黄/蓝/白
- 外壳材料: 黄铜镀镍/不锈钢
- 防护等级: IP65, IK08
- **Mounting Hole Size: Ø19mm**
- **Shape: Flat Round Ring Illuminated**
- **Operating stroke: about 5mm**
- **Switch Rating: 50mA/DC12V**
- **Contact Configuration: 1NO**
- **Operation Type: Momentary**
- **Terminal Type: Screw Terminal**
- **Lamp Color: Red/Green/Yellow/Orange Blue/White**
- **The Crust Material: Nickel-plated Brass/ Stainless Steel**
- **Protection Degree: IP65, IK08**

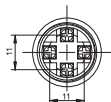
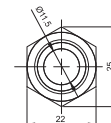
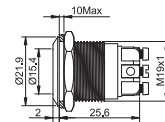

HBGQ22F-10WE/J▲/▲/◎

- 安装孔尺寸: Ø22mm
- 头部形状: 平圆形环带灯
- 操作行程: 约0.5mm
- 开关额定值: 50mA/DC12V
- 开关组合: 1NO
- 操作类型: 自复式
- 接线类型: 接线插片
- 灯珠颜色: 红/绿/黄/蓝/白
- 外壳材料: 黄铜镀镍/不锈钢
- 防护等级: IP65, IK08
- **Mounting Hole Size: Ø22mm**
- **Shape: Flat Round Ring Illuminated**
- **Operating stroke: about 5mm**
- **Switch Rating: 50mA/DC12V**
- **Contact Configuration: 1NO**
- **Operation Type: Momentary**
- **Terminal Type: Pin Terminal**
- **Lamp Color: Red/Green/Yellow/Orange Blue/White**
- **The Crust Material: Nickel-plated Brass/ Stainless Steel**
- **Protection Degree: IP65, IK08**

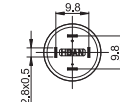
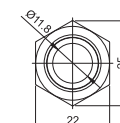
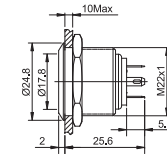

HBGQ22F-11WE/J▲/▲/▲/▲/▲/◎

- 安装孔尺寸: Ø22mm
- 头部形状: 平圆形环带灯
- 操作行程: 约0.5mm
- 开关额定值: 1A/AC125V
- 开关组合: 1NO 1NC
- 操作类型: 自复式
- 接线类型: 接线插片
- 灯珠颜色: 红/绿/黄/蓝/白
- 灯珠颜色多种选择(同时可安装3种颜色), 达到信号识别多样化
- 外壳材料: 黄铜镀镍/不锈钢
- 防护等级: IP65, IK08
- **Mounting Hole Size: Ø22mm**
- **Shape: Flat Round Ring Illuminated**
- **Operating stroke: about 5mm**
- **Switch Rating: 1A/AC125V**
- **Contact Configuration: 1NO 1NC**
- **Operation Type: Momentary**
- **Terminal Type: Pin Terminal**
- **Lamp Color: Red/Green/Yellow/Orange/Blue/White**
- **The Crust Material: Nickel-plated Brass/ Stainless Steel**
- **Protection Degree: IP65, IK08**

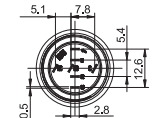
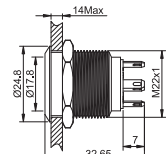

HBGQ



HBGQ22F-10WE/J/△△△△/▲/◎

- 安装孔尺寸: Ø22mm
- 头部形状: 平圆形环形带灯
- 操作行程: 约0.5mm
- 开关额定值: 50mADC12V
- 开关组合: 1NO
- 操作类型: 自复式
- 接线类型: 接线插片
- 灯珠颜色: 红/绿/黄/蓝/白
- 灯珠颜色多种选择 (同时可安装4种颜色), 达到信号识别多样化
- 外壳材料: 黄铜镀镍/不锈钢
- 防护等级: IP65, IK08

- Mounting Hole Size: Ø22mm
- Shape: Flat Round Ring Illuminated
- Operating stroke: about 5mm
- Switch Rating: 50mA/DC12V
- Contact Configuration: 1NO
- Operation Type: Momentary
- Terminal Type: Pin Terminal
- Lamp Color: Red/Green/Yellow/Orange/Blue/White

- The Crust Material: Nickel-plated Brass/ Stainless Steel
- Protection Degree: IP65, IK08

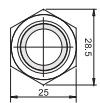
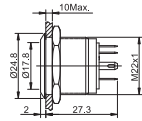

HBGQ22F-11WE/J/△△△△/▲/◎

- 安装孔尺寸: Ø22mm
- 头部形状: 平圆形环形带灯
- 操作行程: 约0.5mm
- 开关额定值: 1A/AC125V
- 开关组合: 1NO 1NC
- 操作类型: 自复式
- 接线类型: 接线插片
- 灯珠颜色: 红/绿/黄/蓝/白
- 灯珠颜色多种选择 (同时可安装4种颜色), 达到信号识别多样化
- 外壳材料: 黄铜镀镍/不锈钢
- 防护等级: IP67, IK08

- Mounting Hole Size: Ø22mm
- Shape: Flat Round Ring Illuminated
- Operating stroke: about 5mm
- Switch Rating: 1A/AC125V
- Contact Configuration: 1NO 1NC
- Operation Type: Momentary
- Terminal Type: Pin Terminal
- Lamp Color: Red/Green/Yellow/Orange/Blue/White

- The Crust Material: Nickel-plated Brass/ Stainless Steel
- Protection Degree: IP67, IK08

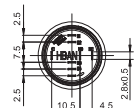
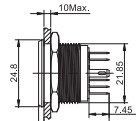

HBGQ25F-11WE/J/△△△△/▲/◎

- 安装孔尺寸: Ø25mm
- 头部形状: 平圆形环形带灯
- 操作行程: 约0.5mm
- 开关额定值: 1A/AC125V
- 开关组合: 1NO
- 操作类型: 自复式
- 接线类型: 接线插片
- 灯珠颜色: 红/绿/黄/蓝/白
- 灯珠颜色多种选择 (同时可安装4种颜色), 达到信号识别多样化
- 外壳材料: 黄铜镀镍/不锈钢
- 防护等级: IP67, IK08

- Mounting Hole Size: Ø25mm
- Shape: Flat Round Ring Illuminated
- Operating stroke: about 5mm
- Switch Rating: 1A/AC125V
- Contact Configuration: 1NO 1NC
- Operation Type: Momentary
- Terminal Type: Pin Terminal
- Lamp Color: Red/Green/Yellow/Orange/Blue/White

- The Crust Material: Nickel-plated Brass/ Stainless Steel
- Protection Degree: IP67, IK08

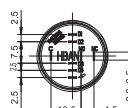
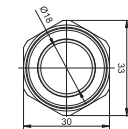
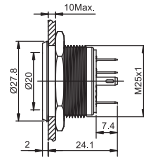

HBGQ Metal Electronic Switch Series



HBGQ30F-11WE/J/△△△△/▲/◎

- 安装孔尺寸: Ø30mm
- 头部形状: 平圆形环形带灯
- 操作行程: 约0.5mm
- 开关额定值: 1A/AC125V
- 开关组合: 1NO 1NC
- 操作类型: 自复式
- 接线类型: 接线插片
- 灯珠颜色: 红/绿/黄/蓝/白
- 灯珠颜色多种选择 (同时可安装4种颜色), 达到信号识别多样化
- 外壳材料: 黄铜镀镍/不锈钢
- 防护等级: IP67, IK08

- Mounting Hole Size: Ø30mm
- Shape: Flat Round Ring Illuminated
- Operating stroke: about 5mm
- Switch Rating: 1A/AC125V
- Contact Configuration: 1NO 1NC
- Operation Type: Momentary
- Terminal Type: Pin Terminal
- Lamp Color: Red/Green/Yellow/Orange/Blue/White

- The Crust Material: Nickel-plated Brass/ Stainless Steel
- Protection Degree: IP67, IK08

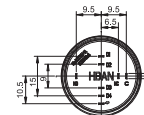
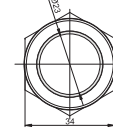
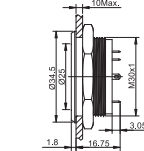

HBGQ19F-10WE/P/△△△△/▲/◎

- 安装孔尺寸: Ø19mm
- 头部形状: 平圆形环形带灯
- 操作行程: 约0.5mm
- 开关额定值: 50mADC12V
- 开关组合: 1NO
- 操作类型: 自复式
- 接线类型: 1.25mm接线插
- 灯珠颜色: 红/绿/黄/蓝/白
- 灯珠颜色多种选择 (同时可安装3种颜色), 达到信号识别多样化
- 外壳材料: 黄铜镀镍/不锈钢
- 防护等级: IP65, IK08

- Mounting Hole Size: Ø19mm
- Shape: Flat Round Ring Illuminated
- Operating stroke: about 5mm
- Switch Rating: 50A/DC12V
- Contact Configuration: 1NO
- Operation Type: Momentary
- Terminal Type: 1.25mm Terminal block
- Lamp Color: Red/Green/Yellow/Orange/Blue/White

- The Crust Material: Nickel-plated Brass/ Stainless Steel
- Protection Degree: IP65, IK08

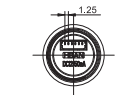
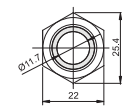
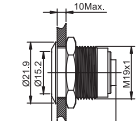

HBGQ22F-10WE/P/△△△△/▲/◎

- 安装孔尺寸: Ø22mm
- 头部形状: 平圆形环形带灯
- 操作行程: 约0.5mm
- 开关额定值: 50mADC12V
- 开关组合: 1NO
- 操作类型: 自复式
- 接线类型: 1.25mm接线插
- 灯珠颜色: 红/绿/黄/蓝/白
- 灯珠颜色多种选择 (同时可安装3种颜色), 达到信号识别多样化
- 外壳材料: 黄铜镀镍/不锈钢
- 防护等级: IP65, IK08

- Mounting Hole Size: Ø22mm
- Shape: Flat Round Ring Illuminated
- Operating stroke: about 5mm
- Switch Rating: 50A/DC12V
- Contact Configuration: 1NO
- Operation Type: Momentary
- Terminal Type: 1.25mm Terminal block
- Lamp Color: Red/Green/Yellow/Orange/Blue/White

- The Crust Material: Nickel-plated Brass/ Stainless Steel
- Protection Degree: IP65, IK08

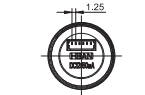
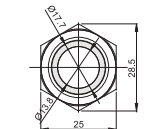
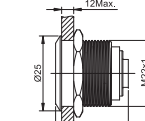

HBGQ



HBGQ22F-10WE/P/△△△△/▲/◎

- 安装孔尺寸: Ø22mm
- 头部形状: 平圆形环带灯
- 操作行程: 约0.5mm
- 开关额定值: 50mA/DC12V
- 开关组合: 1NO
- 操作类型: 自复式
- 接线类型: 引线式22AWG
- 灯珠颜色: 红/绿/黄/橙/蓝/白
- 灯珠颜色多种选择(同时可安装4种颜色), 达到信号识别多样化
- 外壳材料: 黄铜镀镍/不锈钢
- 防护等级: IP65, IK08
- Mounting Hole Size: Ø22mm
- Shape: Flat Round Ring Illuminated
- Operating stroke: about 5mm
- Switch Rating: 50A/DC12V
- Contact Configuration: 1NO
- Operation Type: Momentary
- Terminal Type: 1.25mm Terminal block
- Lamp Color: Red/Green/Yellow/Orange/Blue/White
- The Crust Material: Nickel-plated Brass/ Stainless Steel
- Protection Degree: IP65, IK08

HBGQ16F-10WE/Y/△△/▲/◎

- 安装孔尺寸: Ø16mm
- 头部形状: 平圆形环带灯
- 操作行程: 约0.5mm
- 开关额定值: 50mA/DC12V
- 开关组合: 1NO
- 操作类型: 自复式
- 接线类型: 引线式22AWG
- 灯珠颜色: 红/绿/黄/橙/蓝/白(双色可选)
- 外壳材料: 黄铜镀镍/不锈钢
- 防护等级: IP65, IK08
- Mounting Hole Size: Ø16mm
- Shape: Flat Round Ring Illuminated
- Operating stroke: about 5mm
- Contact Configuration: 1NO
- Operation Type: Momentary
- Terminal Type: 1.25mm Terminal block
- Lamp Color: Red/Green/Yellow/Orange/Blue/White(Could be bi-color LED)
- The Crust Material: Nickel-plated Brass/ Stainless Steel
- Protection Degree: IP65, IK08

HBGQ19F-10WE/Y/△△△△/▲/◎

- 安装孔尺寸: Ø19mm
- 头部形状: 平圆形环带灯
- 操作行程: 约0.5mm
- 开关额定值: 50mA/DC12V
- 开关组合: 1NO
- 操作类型: 自复式
- 接线类型: 引线式22AWG
- 灯珠颜色: 红/绿/黄/橙/蓝/白
- 灯珠颜色多种选择(同时可安装4种颜色), 达到信号识别多样化
- 外壳材料: 黄铜镀镍/不锈钢
- 防护等级: IP65, IK08
- Mounting Hole Size: Ø19mm
- Shape: Flat Round Ring Illuminated
- Operating stroke: about 5mm
- Switch Rating: 50A/DC12V
- Contact Configuration: 1NO
- Operation Type: Momentary
- Terminal Type: 1.25mm Terminal block
- Lamp Color: Red/Green/Yellow/Orange/Blue/White
- The Crust Material: Nickel-plated Brass/ Stainless Steel
- Protection Degree: IP65, IK08

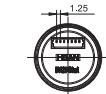
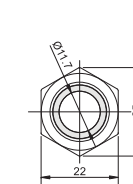
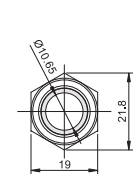
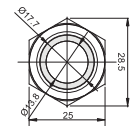
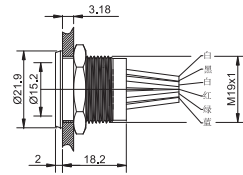
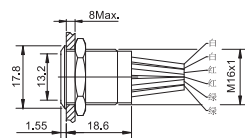
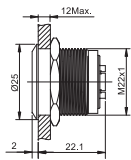

HBGQ Metal Electronic Switch Series



HBGQ22F-10WE/Y/△△△△/▲/◎

- 安装孔尺寸: Ø22mm
- 头部形状: 平圆形环带灯
- 操作行程: 约0.5mm
- 开关额定值: 50mA/DC12V
- 开关组合: 1NO
- 操作类型: 自复式
- 接线类型: 引线式22AWG
- 灯珠颜色: 红/绿/黄/橙/蓝/白
- 灯珠颜色多种选择(同时可安装4种颜色), 达到信号识别多样化
- 外壳材料: 黄铜镀镍/不锈钢
- 防护等级: IP65, IK08
- Mounting Hole Size: Ø22mm
- Shape: Flat Round Ring Illuminated
- Operating stroke: about 5mm
- Switch Rating: 50A/DC12V
- Contact Configuration: 1NO
- Operation Type: Momentary
- Terminal Type: 1.25mm Terminal block
- Lamp Color: Red/Green/Yellow/Orange/Blue/White
- The Crust Material: Nickel-plated Brass/ Stainless Steel
- Protection Degree: IP65, IK08

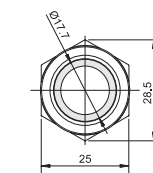
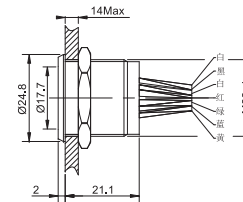

HBGQ25F-11WE/Y/△△△△/▲/◎

- 安装孔尺寸: Ø25mm
- 头部形状: 平圆形环带灯
- 操作行程: 约0.5mm
- 开关额定值: 1A/AC125V
- 开关组合: 1NO 1NC
- 操作类型: 自复式
- 接线类型: 引线式22AWG
- 灯珠颜色: 红/绿/黄/橙/蓝/白
- 灯珠颜色多种选择(同时可安装4种颜色), 达到信号识别多样化
- 外壳材料: 黄铜镀镍/不锈钢
- 防护等级: IP65, IK08
- Mounting Hole Size: Ø25mm
- Shape: Flat Round Ring Illuminated
- Operating stroke: about 5mm
- Switch Rating: 1A/AC125V
- Contact Configuration: 1NO 1NC
- Operation Type: Momentary
- Terminal Type: 1.25mm Terminal block
- Lamp Color: Red/Green/Yellow/Orange/Blue/White
- The Crust Material: Nickel-plated Brass/ Stainless Steel
- Protection Degree: IP65, IK08

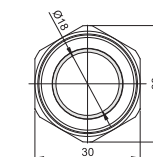
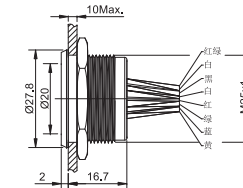

HBGQ



HBGQ35F-10WE/P/△/▲/◎

- 安装孔尺寸: Ø35mm
- 头部形状: 平圆形环形带灯
- 操作行程: 约0.5mm
- 开关额定值: 50mA/DC12V
- 开关组合: 1NO
- 操作类型: 自复式
- 接线类型: 1.25mm接线排
- 灯珠颜色: 红/绿/黄/橙/蓝/白
- 外壳材料: 黄铜镀镍/不锈钢
- 防护等级: IP65, IK08

- **Mounting Hole Size: Ø35mm**
- **Shape: Flat Round Ring Illuminated**
- **Operating stroke: about 5mm**
- **Switch Rating: 50mA/DC12V**
- **Contact Configuration: 1NO**
- **Operation Type: Momentary**
- **Terminal Type: 1.25mm Terminal block**
- **Lamp Color: Red/Green/Yellow/Orange Blue/White**
- **The Crust Material: Nickel-plated Brass/ Stainless Steel**
- **Protection Degree: IP65, IK08**

HBGQ35F-10WE/P/△/▲/◎(SOS)

- 安装孔尺寸: Ø35mm
- 头部形状: 平圆形环形带灯
- 操作行程: 约0.5mm
- 开关额定值: 50mA/DC12V
- 开关组合: 1NO
- 操作类型: 自复式
- 接线类型: 1.25mm接线排
- 灯珠颜色: 红/绿/黄/橙/蓝/白
- 外壳材料: 黄铜镀镍/不锈钢
- 防护等级: IP65, IK08

- **Mounting Hole Size: Ø35mm**
- **Shape: Flat Round Ring Illuminated**
- **Operating stroke: about 5mm**
- **Switch Rating: 50mA/DC12V**
- **Contact Configuration: 1NO**
- **Operation Type: Momentary**
- **Terminal Type: 1.25mm Terminal block**
- **Lamp Color: Red/Green/Yellow/Orange Blue/White**
- **The Crust Material: Nickel-plated Brass/ Stainless Steel**
- **Protection Degree: IP65, IK08**

HBGQ35F-10WE/P/△/▲/◎(求助)

- 安装孔尺寸: Ø35mm
- 头部形状: 平圆形环形带灯
- 操作行程: 约0.5mm
- 开关额定值: 50mA/DC12V
- 开关组合: 1NO
- 操作类型: 自复式
- 接线类型: 1.25mm接线排
- 灯珠颜色: 红/绿/黄/橙/蓝/白
- 外壳材料: 黄铜镀镍/不锈钢
- 防护等级: IP65, IK08

- **Mounting Hole Size: Ø35mm**
- **Shape: Flat Round Ring Illuminated**
- **Operating stroke: about 5mm**
- **Switch Rating: 50mA/DC12V**
- **Contact Configuration: 1NO**
- **Operation Type: Momentary**
- **Terminal Type: 1.25mm Terminal block**
- **Lamp Color: Red/Green/Yellow/Orange Blue/White**
- **The Crust Material: Nickel-plated Brass/ Stainless Steel**
- **Protection Degree: IP65, IK08**

